

NEW BABY COLLET

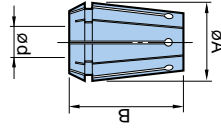

Renowned for its unmatched accuracy and precision. It offers runout accuracy of 1 micron T.I.R. at the collet nose.

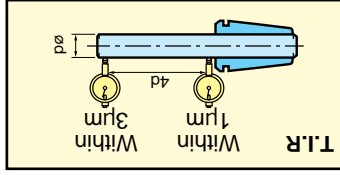

NEW BABY ENDMILL COLLET

FOR ENDMILL



The tolerance of a tool shank must be less than h7.

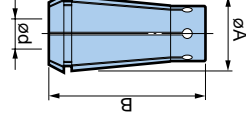

MEGA6N

Model	Clamping Range ød
NBC 6-0.5 AA	0.25 - 0.50
-0.75AA	0.50 - 0.75
-1 AA	1.00 - 1.25
-1.5 AA	1.25 - 1.50
-1.75AA	1.50 - 1.75
-2 AA	1.75 - 2.00
-2.25AA	2.00 - 2.25
-2.5AA	2.25 - 2.50
-2.75AA	2.50 - 2.75
-3 AA	2.75 - 3.00
-3.175AA	2.925 - 3.175
-3.25AA	3.00 - 3.25
-3.5AA	3.25 - 3.50
-3.75AA	3.50 - 3.75
-4 AA	3.75 - 4.00
-4.25AA	4.00 - 4.25
-4.5AA	4.25 - 4.50
-4.75AA	4.50 - 4.75
-5 AA	4.75 - 5.00
-5.25AA	5.00 - 5.25
-5.5AA	5.25 - 5.50
-5.75AA	5.50 - 5.75
-6 AA	5.75 - 6.00

øA=9.5 B=14

Model	Clamping Range ød
NBC13-3 AA	2.5 - 3.0
-3.175AA	2.925 - 3.175
-3.5AA	3.0 - 3.5
-4 AA	3.5 - 4.0
-4.5AA	4.0 - 4.5
-5 AA	4.5 - 5.0
-5.5AA	5.0 - 5.5
-6 AA	5.5 - 6.0
-6.5AA	6.0 - 6.5
-7 AA	6.5 - 7.0
-7.5AA	7.0 - 7.5
-8 AA	7.5 - 8.0
-8.5AA	8.0 - 8.5
-9 AA	8.5 - 9.0
-9.5AA	9.0 - 9.5
-10 AA	9.5 - 10.0
-10.5AA	10.0 - 10.5
-11 AA	10.5 - 11.0
-11.5AA	11.0 - 11.5
-12 AA	11.5 - 12.0
-12.5AA	12.0 - 12.5
-13 AA	12.5 - 13.0

øA=20.5 B=31

Model	Clamping Range ød
NBC 6-3E AA	3.0 - 4.0
-4E AA	4.0 - 5.0
-5E AA	5.0 - 6.0
-6E AA	6.0 - 8.0

øA=9.2 B=17

Model	Clamping Range ød
NBC 8-3E AA	3.0 - 4.0
-4E AA	4.0 - 5.0
-5E AA	5.0 - 6.0
-6E AA	6.0 - 8.0

øA=12 B=20

Model	Clamping Range ød
NBC16-3E AA	3.0 - 4.0
-4E AA	4.0 - 5.0
-5E AA	5.0 - 6.0
-6E AA	6.0 - 8.0

øA=20 B=38

Model	Clamping Range ød
NBC13-3E AA	3.0 - 4.0
-4E AA	4.0 - 5.0
-5E AA	5.0 - 6.0
-6E AA	6.0 - 8.0
-10E AA	10.0 - 12.0
-12E AA	12.0 - 14.0
-16E AA	16.0 - 20.0

øA=25 B=42

Model	Clamping Range ød
NBC20-3E AA	3.0 - 4.0
-4E AA	4.0 - 5.0
-5E AA	5.0 - 6.0
-6E AA	6.0 - 8.0
-10E AA	10.0 - 12.0
-12E AA	12.0 - 14.0
-14E AA	14.0 - 16.0
-16E AA	16.0 - 20.0

øA=28 B=45

MEGA8N

Model	Clamping Range ød
NBC 8-1 AA	0.5 - 1.0
-1.5 AA	1.0 - 1.5
-2 AA	1.5 - 2.0
-2.5 AA	2.0 - 2.5
-3 AA	2.5 - 3.0
-3.175AA	2.925 - 3.175
-3.5 AA	3.0 - 3.5
-4 AA	3.5 - 4.0
-4.5 AA	4.0 - 4.5
-5 AA	4.5 - 5.0
-5.5 AA	5.0 - 5.5
-6 AA	5.5 - 6.0
-6.5 AA	6.0 - 6.5
-7 AA	6.5 - 7.0
-7.5 AA	7.0 - 7.5
-8 AA	7.5 - 8.0

øA=12.5 B=18

Model	Clamping Range ød
NBC16-3 AA	2.5 - 3.0
-3.5AA	3.0 - 3.5
-4 AA	3.5 - 4.0
-4.5AA	4.0 - 4.5
-5 AA	4.5 - 5.0
-5.5AA	5.0 - 5.5
-6 AA	5.5 - 6.0
-6.5AA	6.0 - 6.5
-7 AA	6.5 - 7.0
-7.5AA	7.0 - 7.5
-8 AA	7.5 - 8.0
-8.5AA	8.0 - 8.5
-9 AA	8.5 - 9.0
-9.5AA	9.0 - 9.5
-10 AA	9.5 - 10.0
-10.5AA	10.0 - 10.5
-11 AA	10.5 - 11.0
-11.5AA	11.0 - 11.5
-12 AA	11.5 - 12.0
-12.5AA	12.0 - 12.5
-13 AA	12.5 - 13.0
-13.5AA	13.0 - 13.5
-14 AA	13.5 - 14.0
-14.5AA	14.0 - 14.5
-15 AA	14.5 - 15.0
-15.5AA	15.0 - 15.5
-16 AA	15.5 - 16.0

øA=25.5 B=35

øA=28.5 B=38

Model	Clamping Range ød
NBC10-3E AA	3.0 - 4.0
-4E AA	4.0 - 5.0
-5E AA	5.0 - 6.0
-6E AA	6.0 - 8.0
-8E AA	8.0 - 10.0

øA=16 B=32

Model	Clamping Range ød
NBC10-3E AA	3.0 - 4.0
-4E AA	4.0 - 5.0
-5E AA	5.0 - 6.0
-6E AA	6.0 - 8.0
-10E AA	10.0 - 12.0

øA=28 B=45

MEGA10N

Model	Clamping Range ød
NBC10-2 AA	1.5 - 2.0
-2.5 AA	2.0 - 2.5
-3 AA	2.5 - 3.0
-3.175AA	2.925 - 3.175
-3.5 AA	3.0 - 3.5
-4 AA	3.5 - 4.0
-4.5 AA	4.0 - 4.5
-5 AA	4.5 - 5.0
-5.5 AA	5.0 - 5.5
-6 AA	5.5 - 6.0
-6.5 AA	6.0 - 6.5
-7 AA	6.5 - 7.0
-7.5 AA	7.0 - 7.5
-8 AA	7.5 - 8.0
-8.5 AA	8.0 - 8.5
-9 AA	8.5 - 9.0
-9.5 AA	9.0 - 9.5
-10 AA	9.5 - 10.0

øA=16.5 B=27

Model	Clamping Range ød
NBC20-3 AA	2.5 - 3.0
-3.5AA	3.0 - 3.5
-4 AA	3.5 - 4.0
-4.5AA	4.0 - 4.5
-5 AA	4.5 - 5.0
-5.5AA	5.0 - 5.5
-6 AA	5.5 - 6.0
-6.5AA	6.0 - 6.5
-7 AA	6.5 - 7.0
-7.5AA	7.0 - 7.5
-8 AA	7.5 - 8.0
-8.5AA	8.0 - 8.5
-9 AA	8.5 - 9.0
-9.5AA	9.0 - 9.5
-10 AA	9.5 - 10.0
-10.5AA	10.0 - 10.5
-11 AA	10.5 - 11.0
-11.5AA	11.0 - 11.5
-12 AA	11.5 - 12.0
-12.5AA	12.0 - 12.5
-13 AA	12.5 - 13.0
-13.5AA	13.0 - 13.5
-14 AA	13.5 - 14.0
-14.5AA	14.0 - 14.5
-15 AA	14.5 - 15.0
-15.5AA	15.0 - 15.5
-16 AA	15.5 - 16.0
-16.5AA	16.0 - 16.5
-17 AA	16.5 - 17.0
-17.5AA	17.0 - 17.5
-18 AA	17.5 - 18.0
-18.5AA	18.0 - 18.5
-19 AA	18.5 - 19.0
-19.5AA	19.0 - 19.5
-20 AA	19.5 - 20.0

øA=28.5 B=38

Model	Clamping Range ød
NBC10-3E AA	3.0 - 4.0
-4E AA	4.0 - 5.0
-5E AA	5.0 - 6.0
-6E AA	6.0 - 8.0
-8E AA	8.0 - 10.0

øA=16 B=32

Model	Clamping Range ød
NBC10-3E AA	3.0 - 4.0
-4E AA	4.0 - 5.0
-5E AA	5.0 - 6.0
-6E AA	6.0 - 8.0
-10E AA	10.0 - 12.0

øA=28 B=45

MEGA PERFECT SEAL PAT.

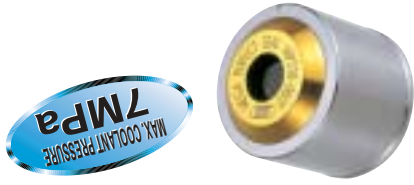

Reliable coolant supply to the tool tip!
Unique design increases sealing performance with higher coolant pressure to create a "perfect seal".

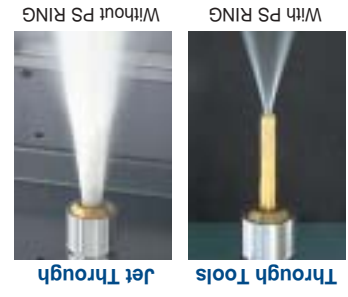

• Replaceable seal is installed in MEGA PERFECT SEAL
(Spare seal is recommended when coolant leaks due to damage of PS Ring.)

MEGA PERFECT SEAL PAT. Sealed collet nut for coolant-through tools

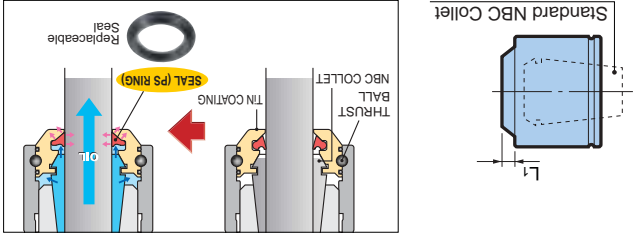

Model	Cutter Shank Dia. L1	Collet Model	Clamping Range ød
MPS 6-03035	3 - 3.5	NBC 6-3 - 3.75	3 - 3.5
-0304	3 - 4	NBC 8-3 - 4	3 - 3.5
-0405	4 - 4.5	NBC 10-3 - 4	3 - 3.5
-0405	4 - 4.5	NBC 13-3 - 4	3 - 3.5
-0506	5 - 6		3 - 3.5
-0505	5 - 5.5		3 - 3.5
-0405	4 - 4.5		3 - 3.5
-0405	4 - 4.5		3 - 3.5
-0405	4 - 4.5		3 - 3.5
-0506	5 - 6		3 - 3.5
-0607	6 - 7		3 - 3.5
-0705	7 - 7.5		3 - 3.5
-0708	7 - 8		3 - 3.5
-0808	8 - 8.5		3 - 3.5
-0809	8 - 9		3 - 3.5
-0910	9 - 9.5		3 - 3.5
-0910	9 - 10		3 - 3.5
-1010	10 - 10.5		3 - 3.5
-1011	10 - 11		3 - 3.5
-1115	11 - 11.5		3 - 3.5
-1112	11 - 12		3 - 3.5
-1213	12 - 12.5		3 - 3.5
-1213	12 - 13		3 - 3.5
-1314	13 - 14		3 - 3.5
-1415	14 - 15		3 - 3.5
-1516	15 - 16		3 - 3.5
MPS16-03035	3 - 3.5		3 - 3.5
-0304	3 - 4		3 - 3.5
-0405	4 - 4.5		3 - 3.5
-0505	5 - 5.5		3 - 3.5
-0506	5 - 6		3 - 3.5
-0606	6 - 6.5		3 - 3.5
-0607	6 - 7		3 - 3.5
-0705	7 - 7.5		3 - 3.5
-0708	7 - 8		3 - 3.5
-0808	8 - 8.5		3 - 3.5
-0809	8 - 9		3 - 3.5
-0909	9 - 9.5		3 - 3.5
-0910	9 - 10		3 - 3.5
-1010	10 - 10.5		3 - 3.5
-1011	10 - 11		3 - 3.5
-1115	11 - 11.5		3 - 3.5
-1112	11 - 12		3 - 3.5
-1213	12 - 12.5		3 - 3.5
-1213	12 - 13		3 - 3.5
-1314	13 - 14		3 - 3.5
-1415	14 - 15		3 - 3.5
-1516	15 - 16		3 - 3.5
MPS20-03035	3 - 3.5		3 - 3.5
-0304	3 - 4		3 - 3.5
-0405	4 - 4.5		3 - 3.5
-0505	5 - 5.5		3 - 3.5
-0506	5 - 6		3 - 3.5
-0606	6 - 6.5		3 - 3.5
-0607	6 - 7		3 - 3.5
-0705	7 - 7.5		3 - 3.5
-0708	7 - 8		3 - 3.5
-0808	8 - 8.5		3 - 3.5
-0809	8 - 9		3 - 3.5
-0909	9 - 9.5		3 - 3.5
-0910	9 - 10		3 - 3.5
-1010	10 - 10.5		3 - 3.5
-1011	10 - 11		3 - 3.5
-1115	11 - 11.5		3 - 3.5
-1112	11 - 12		3 - 3.5
-1213	12 - 12.5		3 - 3.5
-1213	12 - 13		3 - 3.5
-1314	13 - 14		3 - 3.5
-1415	14 - 15		3 - 3.5
-1516	15 - 16		3 - 3.5
MPS10-03035	3 - 3.5		3 - 3.5
-0304	3 - 4		3 - 3.5
-0405	4 - 4.5		3 - 3.5
-0405	4 - 4.5		3 - 3.5
-0505	5 - 5.5		3 - 3.5
-0506	5 - 6		3 - 3.5
-0607	6 - 7		3 - 3.5
-0705	7 - 7.5		3 - 3.5
-0708	7 - 8		3 - 3.5
-0808	8 - 8.5		3 - 3.5
-0809	8 - 9		3 - 3.5
-0909	9 - 9.5		3 - 3.5
-0910	9 - 10		3 - 3.5
-1010	10 - 10.5		3 - 3.5
-1011	10 - 11		3 - 3.5
-1115	11 - 11.5		3 - 3.5
-1112	11 - 12		3 - 3.5
-1213	12 - 12.5		3 - 3.5
-1213	12 - 13		3 - 3.5
-1314	13 - 14		3 - 3.5
-1415	14 - 15		3 - 3.5
-1516	15 - 16		3 - 3.5
MPS13-03035	3 - 3.5		3 - 3.5
-0304	3 - 4		3 - 3.5
-0405	4 - 4.5		3 - 3.5
-0405	4 - 4.5		3 - 3.5
-0505	5 - 5.5		3 - 3.5
-0506	5 - 6		3 - 3.5
-0607	6 - 7		3 - 3.5
-0705	7 - 7.5		3 - 3.5
-0708	7 - 8		3 - 3.5
-0808	8 - 8.5		3 - 3.5
-0809	8 - 9		3 - 3.5
-0909	9 - 9.5		3 - 3.5
-0910	9 - 10		3 - 3.5
-1010	10 - 10.5		3 - 3.5
-1011	10 - 11		3 - 3.5
-1115	11 - 11.5		3 - 3.5
-1112	11 - 12		3 - 3.5
-1213	12 - 12.5		3 - 3.5
-1213	12 - 13		3 - 3.5
-1314	13 - 14		3 - 3.5
-1415	14 - 15		3 - 3